

Vancouver 2009 Floor Plan

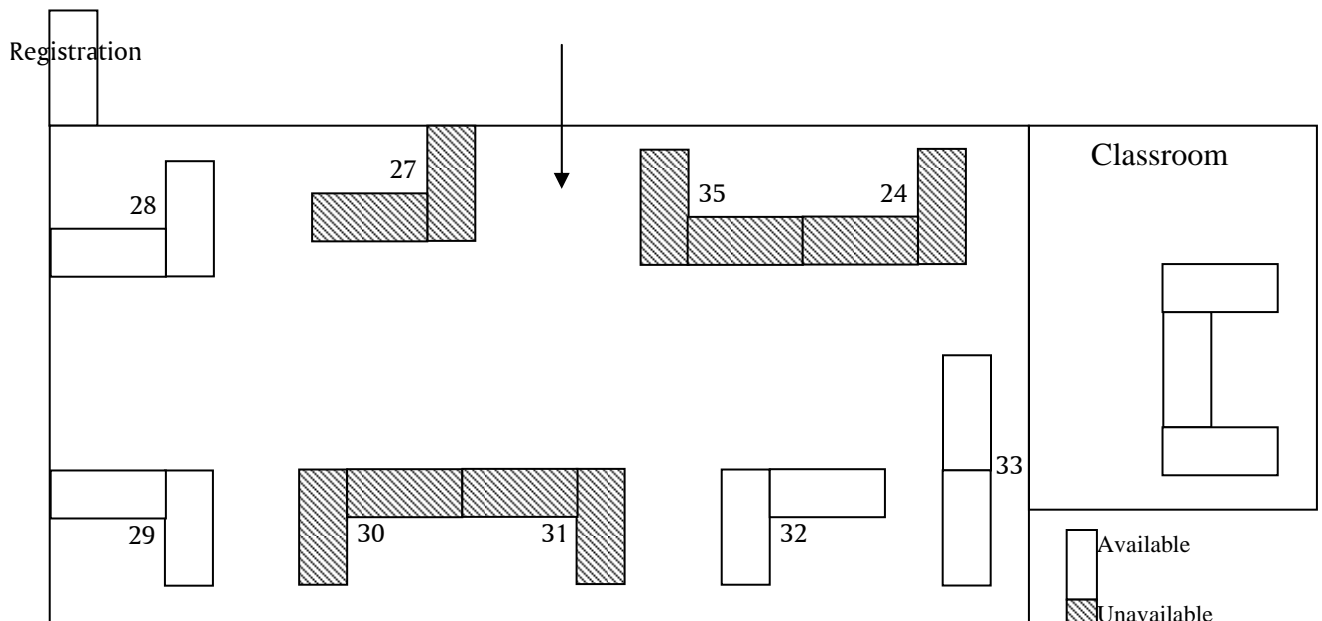
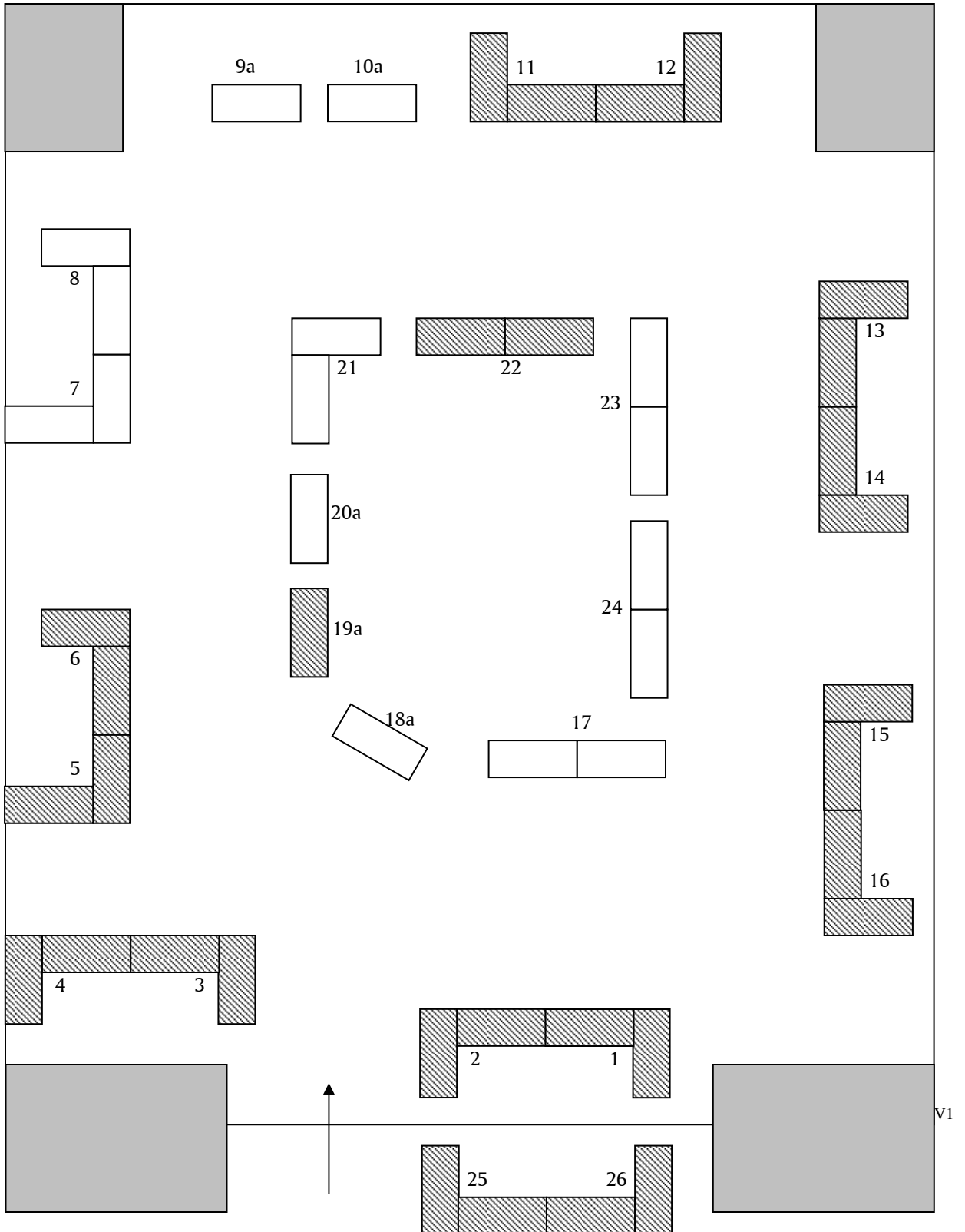

Note to Returning Merchants:
 We will start assigning space to new merchants on 5/4/08. This gives returning merchants time to retain their space or make requests to be moved. We never automatically sign up merchants and will need a request form and payment for each individual show to assign and hold space. We will not be held responsible if the show sells out in the first 30 days and the returning merchant does not get a space. Updated May 21, 2008

** Subject to Change*