

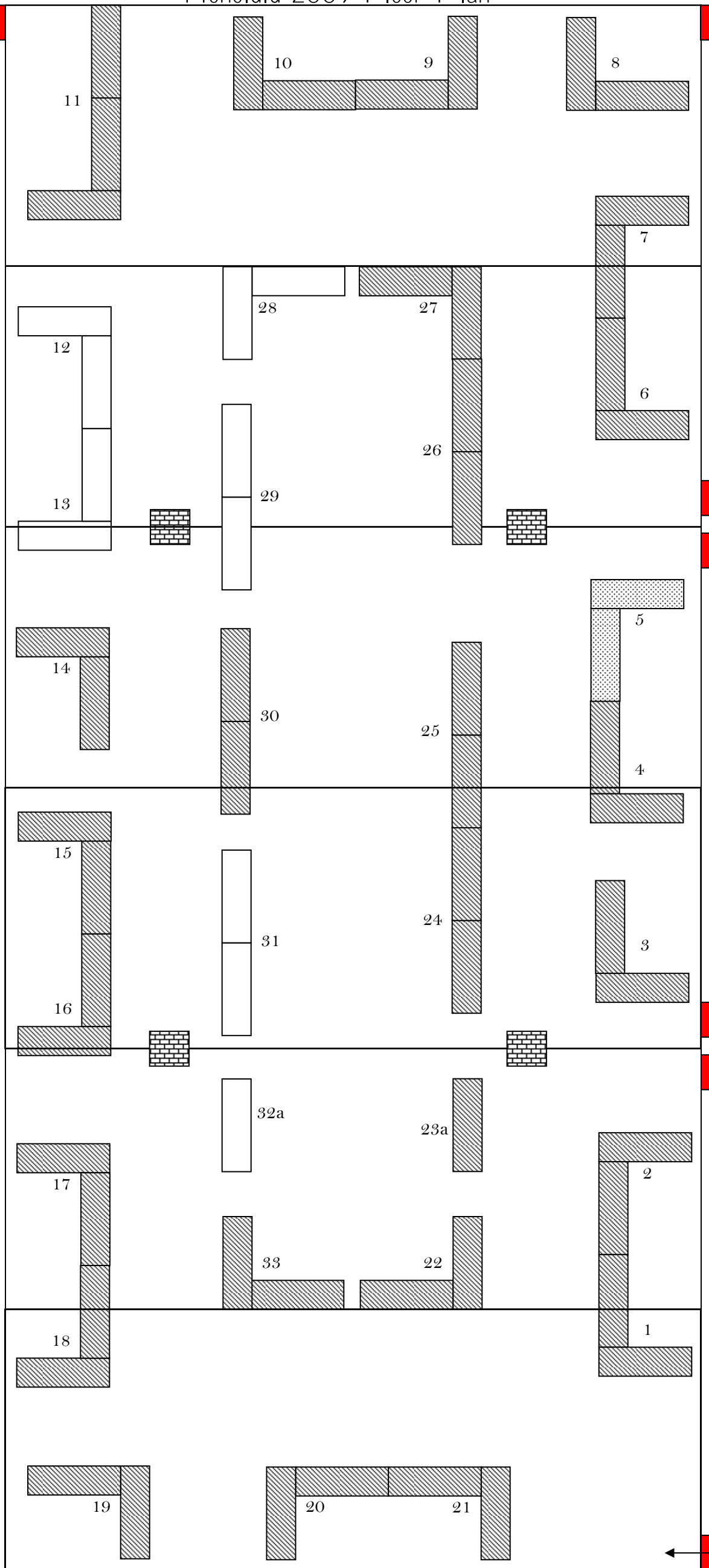



# Honolulu 2009 Floor Plan

Note to Returning Merchants:  
 We will start assigning space to new merchants on 2/10/07. This gives returning merchants time to retain their space or make requests to be moved. We will not be held responsible if the show sells out in the first 30 days and the returning merchant does not get any space.  
 Thank You

Updated  
 August 14, 2008



-  Available
-  Unavailable
-  Pending

*\* Subject to Change*